

# Installation Manual

## Lowering Kit Type MP 1

For Harley-Davidson® Milwaukee-Eight Softail® Models ab 2018 and up



An assembly video can be found at  
[videos.m-motorcycle.de/einbauanleitungen/130-30-en.mp4](https://videos.m-motorcycle.de/einbauanleitungen/130-30-en.mp4)

### Fits following models:

FXBR/FXBRS	Breakout®
FLDE	Deluxe®
FLFB/FLFBS	Fat Boy®
FLHC/FLHCS	Heritage Classic®
FXFB/FXFBFS	Fat Bob®
FLSB	Sport Glide®

**Conversion kit MP1 – Art.-Nr. 130-30/1304-065** includes a lowering eye with bearing, thread adapter and a spring washer.

### Special tools needed for mounting:

Spring compressor

(we recommend the Müller spring compression tool, Part. -Nr.: 130-0)



**Caution:** The installation should be carried out by qualified personnel or a certified workshop to ensure driving safety!

### Installation Manual:

1. Make sure your bike has a safe stand by using a hydraulic ramp and an appropriate motorcycle jack.



2. Demount your strut assembly from your bike. Undo all necessary screws, bolts and clamps.

3. Fasten your strut in the Compression tool and make sure it is properly fitted in the tool.

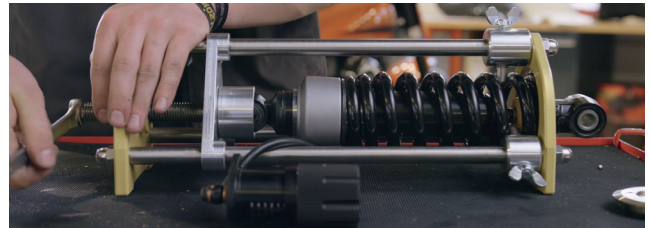

4. Preload the damper as far as you reach the hexagon nut of the strut eye.

5. Heat up the strut eye with a heat gun and loosen the counter nut.

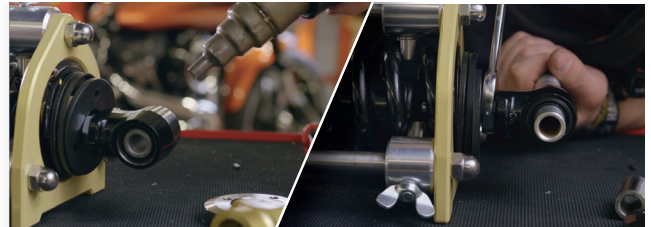

6. Remove all original parts.



7. Shorten the rubber stop by approx. 7-8 mm.

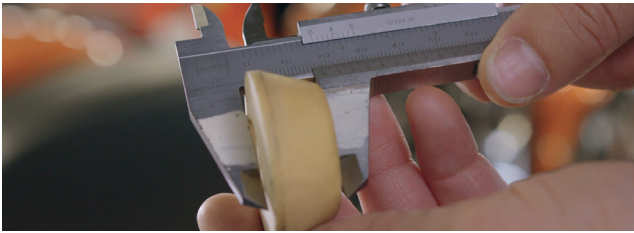

8. Put the rubber stop back on the damper rod.



**!!! Attention, now we get to the actual height adjustment !!!!**

9. The height of the bike will be adjusted with the spring washer (Pos. 3). For a maximum lowering of 35mm you must rotate the spring washer (Pos.3) onto the damper rod all the way to the stop and then 1 complete rotation backwards.

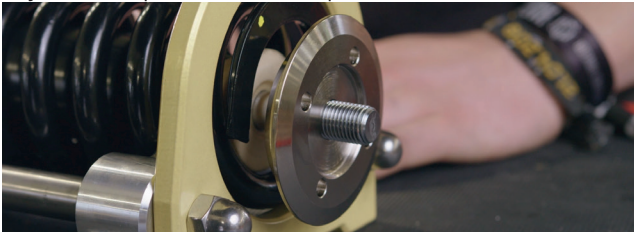

(for show purposes only, you can lower the bike by 40mm, rotating the spring washer (Pos.3) all the way onto the damper rod)

**Note:** If you don't want it all the way lowered by 35mm, following rule applies: With every complete turn of the spring washer (Pos. 3) backwards, the tail comes up by 3mm. That is how you achieve your personal desired level of lowering.

10. Now screw on the thread adapter (Pos.4) with the two drillings facing towards the spring washer (Pos. 3) onto the damper rod and counter secure it with the spring washer (Pos.3). Max. torque for tightening is 25 Nm!

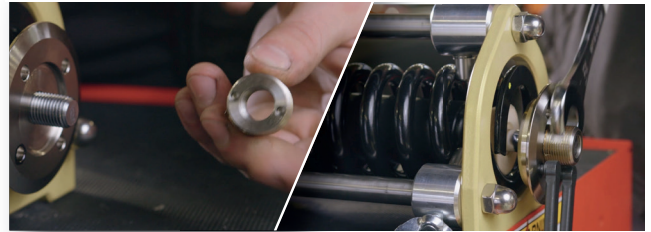

11. Take the new lowering eye (Pos. 2) and screw it all the way onto the thread adapter (Pos. 4) and counter secure the lowering eye (Pos. 2) with the spring washer (Pos. 3). Max. torque for tightening is 25 Nm!

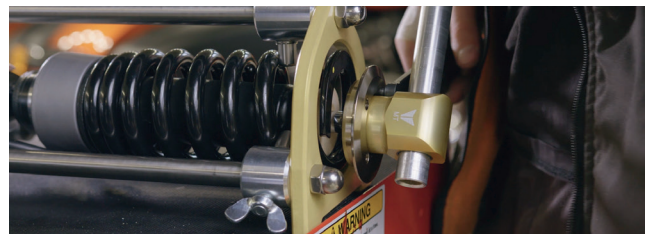

12 For easier assembly of the strut you have to align the drillings with the drillings of the lowering eye.

13. Now you can take out the strut of the compression tool and fix it into your bike. Fasten it with all requires screws.

!! Caution: we recommend checking the height of your chassis before reassembling all bolts and clamps. If you don't like the actual height, remove the strut again and adjust the desired height with the spring washer. If the height is ok you may tighten up everything as needed.

**The Müller Motorcycle AG crew wishes you lots of fun with your new lowering kit and always a pleasant ride!**

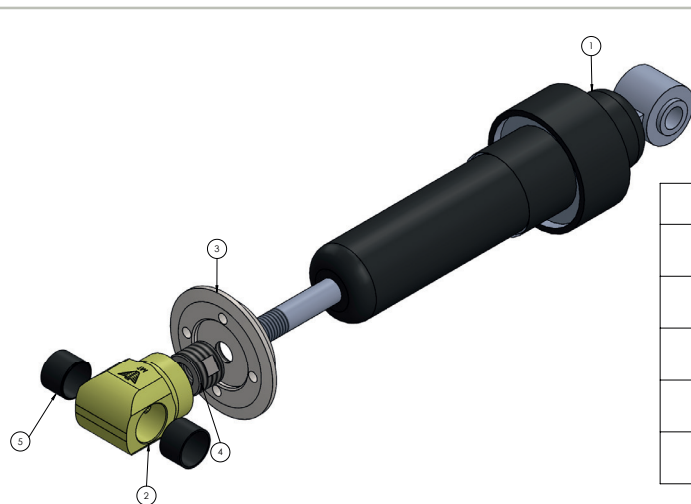

POS	ITEM NUMBER	DESCRIPTION	QUANTITY
1		FXBR org. strut	1
2	A01736	lowering eye 2018	1
3	A01737	spring washer	1
4	A01738	thread adapter	1
5	D0204	bearing	2