

## INSTALLATION INSTRUCTIONS

### PHANTOM MIRRORS, CHROME

1962

### THANK YOU FOR CHOOSING KURYAKYN!

Protect yourself and others from possible injury and property damage or loss. Pay close attention to all instructions, warnings, cautions, and notices regarding the installation, use, and care of this product.

**WARNING** THIS INDICATION ALERTS YOU TO THE FACT THAT IGNORING THE CONTENTS DESCRIBED HEREIN CAN RESULT IN POTENTIAL DEATH OR SERIOUS INJURY.

**CAUTION** THIS INDICATION ALERTS YOU TO THE FACT THAT IGNORING THE CONTENTS DESCRIBED HEREIN CAN RESULT IN MINOR OR MODERATE POTENTIAL INJURY.

**NOTICE** THIS INDICATION ALERTS YOU TO THE FACT THAT IGNORING THE CONTENTS DESCRIBED HEREIN MAY NEGATIVELY AFFECT PRODUCT PERFORMANCE AND FUNCTIONALITY OR DAMAGE THE PRODUCT ITSELF OR THE PRODUCT TO WHICH IT IS BEING ATTACHED.

### ENSURE THAT THE FOLLOWING PARTS HAVE BEEN INCLUDED IN THE KIT:

- |   |              |   |                                      |
|---|--------------|---|--------------------------------------|
| 1 | Left Mirror  | 1 | Hardware Kit, containing:            |
| 1 | Right Mirror | 2 | 5-16-18X 1.5" Socket Head Cap Screws |
|   |              | 2 | 5-16-18 X 2" Socket Head Cap Screws  |
|   |              | 2 | Double Ended Threaded Studs          |
|   |              | 2 | 5/16 Split Lock Washers              |
|   |              | 2 | 5/16 Internal Tooth Lock Washers     |

### YOU WILL ALSO NEED:

Hex wrench set, combination wrench set

**NOTICE** THESE INSTALLATION INSTRUCTIONS CONTAIN IMPORTANT INFORMATION. ENSURE THE END USER RECEIVES THIS COPY AND IS AWARE OF ITS IMPORTANCE FOR FUTURE USE.

**STEP 1** Read and understand all steps in the instructions before starting the installation. Park the motorcycle on a hard, level surface and turn off the ignition. Let motorcycle cool.

*Note: Mirror adapters (sold separately) are required for installation on metric cruisers.*

**NOTICE** AVOID DAMAGE TO THE MOTORCYCLE. PROTECT PAINTED SURFACES WITH A SOFT CLOTH OR BLANKET.

**NOTICE** ENSURE THAT THE POSITION OF THE MIRROR AND STEM DO NOT INTERFERE WITH THE OPERATION OF THE MOTORCYCLE HAND CONTROLS.

**NOTICE** IT IS THE INSTALLER'S RESPONSIBILITY TO ENSURE THAT ALL OF THE FASTENERS (INCLUDING PRE-ASSEMBLED) ARE TIGHTENED BEFORE OPERATION OF THE MOTORCYCLE. KURYAKYN WILL NOT PROVIDE WARRANTY COVERAGE ON PRODUCTS OR COMPONENTS LOST DUE TO IMPROPER INSTALLATION OR LACK OF MAINTENANCE. PERIODIC INSPECTION AND MAINTENANCE ARE REQUIRED ON ALL FASTENERS

**STEP 2** Remove existing mirrors from controls; set them aside, they will not be reused.



## INSTALLATION INSTRUCTIONS

### PHANTOM MIRRORS, CHROME

1962

-CONTINUED-

#### MOUNTING WITH SINGLE SCREW

- STEP 3** Determine which of the included socket head cap screws from the hardware kit will provide maximum thread engagement in the mirror stem without bottoming out.
- STEP 4** Place a split lock washer over the socket head cap screw and insert it in the hole in the hand control. FIG 1
- STEP 5** Place an internal lock washer over the protruding end of the cap screw.
- STEP 6** While holding the mirror in place, thread the socket head cap screw into the bottom of the mirror stem.
- Note: Ensure that the set screw in the mirror stem does not prevent the socket head cap screw from being installed fully. FIG 1*
- STEP 7** Adjust the position of the mirror stem for visibility and clearance; tighten the socket head cap screw and then the set screw.
- STEP 8** Repeat step 3 through 7 for the opposite side.

FIG 1

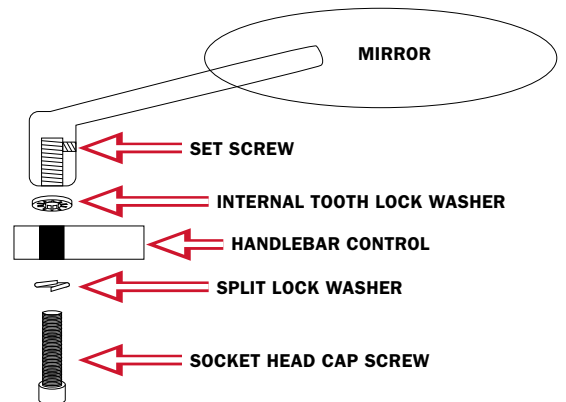

#### H-D WITH BOTTOM MOUNTED TURN SIGNALS

**CAUTION** REMOVING THE RETAINER NUT AND/OR THE BALL STUD CLAMP IN THE NEXT STEP WILL RELEASE THE TURN SIGNALS FROM THE HAND CONTROLS. SECURE THE TURN SIGNALS TO PREVENT DAMAGE OR INJURY.

- STEP 9** Refer to FIG 2. Starting on the right (brake) side. Loosen and remove the retainer nut and ball stud clamp.
- STEP 10** Remove the stock mirror; hold the stock turn signal to prevent it from being damaged.
- STEP 11** Refer to FIG 2. Screw a double ended stud into the new mirror stem; tighten and then tighten the set screw.
- Note: Refer to FIG 2. Ensure that the setscrew in the mirror stem does not prevent the double ended stud from being installed fully.*
- STEP 12** Refer to FIG 2. Place an internal lock washer over the long end of one of the double-ended studs; insert the assembly into the mirror stem hole in the hand control.
- STEP 13** Refer to FIG 2. Place a split lock washer over the protruding end of the double-ended stud and thread the retainer nut onto the stud.
- STEP 14** Adjust the position of the mirror stem for visibility and clearance; tighten the retaining nut.
- STEP 15** Install the ball stud clamp onto the retainer nut; adjust the turn signal and tighten the clamp.
- STEP 16** Repeat step 3 through 7 for the left side.
- STEP 17** Adjust the mirrors for proper view before riding the motorcycle.

FIG 2

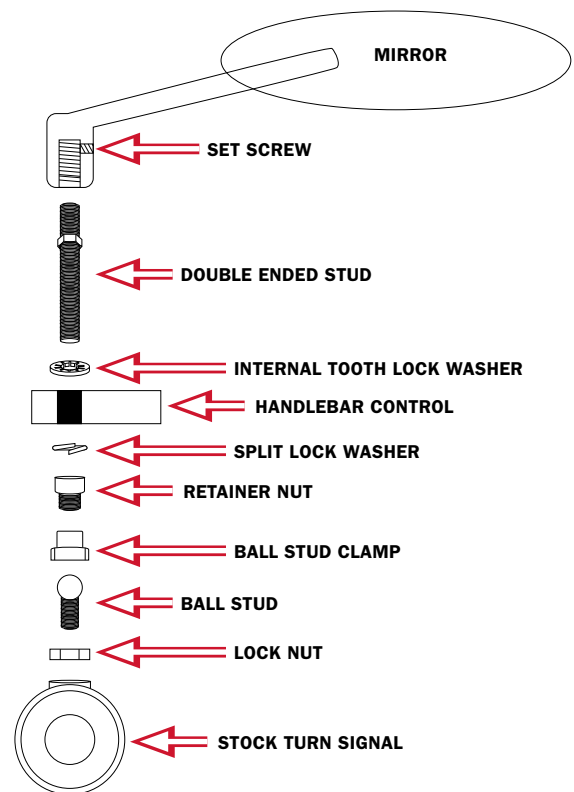

## INSTALLATION INSTRUCTIONS

### PHANTOM MIRRORS, CHROME

1962

-CONTINUED-

#### NOTICE

**IT IS THE INSTALLER'S RESPONSIBILITY TO ENSURE THAT ALL OF THE FASTENERS (INCLUDING PRE-ASSEMBLED) ARE TIGHTENED BEFORE OPERATION OF THE MOTORCYCLE. KURYAKYN WILL NOT PROVIDE WARRANTY COVERAGE ON PRODUCTS OR COMPONENTS LOST DUE TO IMPROPER INSTALLATION OR LACK OF MAINTENANCE. PERIODIC INSPECTION AND MAINTENANCE ARE REQUIRED ON ALL FASTENERS.**

#### LIMITED WARRANTY

Kuryakyn warrants that any Kuryakyn products sold hereunder, shall be free of defects in materials & workmanship for a period of one (1) year from the date of purchase by the consumer excepting the following provisions:

1. Kuryakyn shall have no obligation in the event the customer is unable to provide a receipt showing the date the customer purchased the product(s).
2. The product must be properly installed, maintained & operated under normal conditions.
3. Kuryakyn shall not be liable for any consequential & incidental damages, including labor & paint, resulting from failure of a Kuryakyn product, failure to deliver, delay in delivery, delivery in nonconforming condition, or for any breach of contract or duty between Kuryakyn & a customer.
4. Kuryakyn products are often intended for use in specific applications. Kuryakyn makes no warranty if a Kuryakyn product is used in applications other than intended.
5. Kuryakyn electrical products are warranted for one (1) year from the date of purchase by the consumer. L.E.D.'s contained in components of Kuryakyn products will be warranted for defects in materials & workmanship for 3 years from the date of purchase whereas all other components shall be warranted for one (1) year.
6. All warranty claims must be directed to the place of purchase. Merchandise sold through internet auction sites or any other unauthorized reseller shall not carry a Kuryakyn warranty. If unsure, please contact the place of purchase to verify they are an authorized Kuryakyn reseller.

#### RETURN POLICY

Merchandise determined to be defective may be returned up to one year from the date of purchase. Returns must be processed through original seller. Returned merchandise for any other reason other than warranty claims must be in like new condition & subject to a 20% restocking fee. All returns are subject to inspection for determination of full or partial credit. Any returned part that shows evidence of being used or installed contrary to manufacturer's instructions, &/or subjected to improper handling, packaging or return shipping by the customer, will not be eligible for exchange, refund or warranty consideration. All returned electrical items will be inspected & tested. If electrical item is deemed functional, no credit will be issued & item will be returned. All sales are final on discontinued or closeout merchandise.

©2015 KURYAKYN HOLDINGS, LLC ALL RIGHTS RESERVED

KURYAKYN, KURYAKYN K logo and the marks appearing on this instruction sheet are registered and common law trademarks of Kuryakyn Holdings except noted third-party trademarks. A full listing of trademarks and trademark registrations owned by Kuryakyn Holdings can be found at [www.kuryakyn.com/legal-notice](http://www.kuryakyn.com/legal-notice).

Emissions Notice: The California Air Resources Board (CARB) does not permit the use of aftermarket emission-related parts(s) that alter the performance of OEM emission-related devices unless CARB has issued an Executive Order, other than on racing vehicles on closed courses. Check your local laws and manufacturer's information.

Listed Manufacturers and product model names are for reference only. All product and company names are trademarks or registered trademarks of their respective holders. Use of them does not imply any affiliation with or endorsement by them. All specifications are subject to change without notice.

For additional information on third-party product and company names, please consult our Web page at [www.kuryakyn.com/legal-notice](http://www.kuryakyn.com/legal-notice)