



### L.E.D. CURVED LICENSE PLATE FRAME WITH MOUNT

5699

#### Thank You For Choosing Kuryakyn!

Protect yourself and others from potential injury and property damage or loss. Pay close attention to all instructions, warnings, cautions, and notices regarding the installation, use, and care of this product.

#### **WARNING**

THIS INDICATION ALERTS YOU TO THE FACT THAT IGNORING THE CONTENTS DESCRIBED HEREIN CAN RESULT IN POTENTIAL DEATH OR SERIOUS INJURY.

#### **NOTICE**

This indication alerts you to the fact that ignoring the contents described herein may negatively affect product performance and functionality or damage the product itself or the product to which it is being attached.

#### ENSURE THAT THE FOLLOWING PARTS HAVE BEEN INCLUDED IN THE KIT:

- 1 Backing Plate Assembly
- 1 License Plate Frame Assembly
- 1 Hardware Kit containing:
  - 2 Flat Washers
  - 4 1/4"-20 X 9/16" Flat Socket Cap Screws
  - 2 Cable Ties
  - 1 Foam Block
- 1 Installation Instructions

#### YOU WILL ALSO NEED:

10MM ratcheting box end wrench or metric socket set and ratchet, set of metric hex wrenches, diagonal cutting pliers, warm, soapy water and clean rag.

#### **NOTICE**

These installation instructions contain important information. Ensure that the end user receives this copy and is aware of its importance for future use.

- STEP 1** Read and understand all steps in the instructions before starting the installation. Park the motorcycle on a hard, level surface and turn **IGN OFF**. Allow the engine and exhaust system to cool. Remove the main fuse.
- STEP 2** Prepare a soft, sturdy, clean work surface within arm's reach of the motorcycle's rear fender.
- STEP 3** Refer to **PIC 1**. Locate and remove the three (3) hex flange head screws securing the license plate/brake light/turn signal assembly the rear fender. Use a 10MM ratcheting box end wrench to remove the screws from the inside; set them aside, they will be reused.

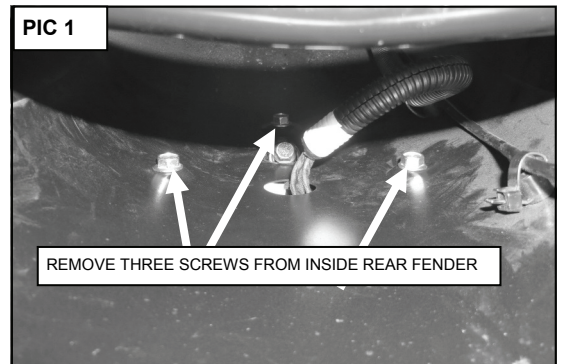

#### **WARNING**

THE END USER'S SAFETY DEPENDS UPON PROPER INSTALLATION OF THIS PRODUCT. IF A STEP IN THESE INSTRUCTIONS IS NOT WITHIN YOUR CAPABILITIES OR YOU DO NOT HAVE THE CORRECT TOOLS, HAVE YOUR DEALER PERFORM THE PROCEDURE. IMPROPER INSTALLATION OF THIS PRODUCT COULD RESULT IN DEATH OR SERIOUS INJURY.

ACCIDENTAL VEHICLE START-UP COULD CAUSE DEATH OR SERIOUS INJURY, REMOVE THE MAIN FUSE BEFORE PROCEEDING.

#### **NOTICE**

Avoid damage to the motorcycle. Protect painted surfaces with a soft cloth or blanket.

**STEP 4** Gently remove the plate/signal assembly from the fender; retain the rubber gasket from behind the assembly.

**STEP 5** Use a diagonal cutting pliers to cut the existing cable tie; disconnect the four connectors; once the assembly is free, set it on the work surface.

**STEP 6** Refer to **PIC 3**. Locate and remove the two (2) hex flange screws from the back side of the plate/signal assembly; set them aside, they will be reused later.

**STEP 7** Refer to **PIC 4**. Locate the included Flat Washers; assemble the Washers with the existing top hat washers and hex head screws; set them within arm's reach of the work area.

**STEP 8** Refer to **PICS 5 and 6**. Locate the included Backing Plate Assembly; align it with the threaded holes in the plate/signal assembly; secure with the screws and washers from **STEP 7**. Tighten the screws.

**STEP 9** Refer to **PICS 7, 8, and 9**. Locate the included License Plate Frame; route the license plate light wiring through the slot in the Backing Plate Assembly.

Carefully curve the license plate to match the contour of the Backing Plate and Frame.

Align the license plate with the Frame and Backing Plate; secure with the four (4) included Flat Head Screws; leave the screws loose until all four have been started in their threads, then tighten.

It may be necessary to enlarge the license plate holes.

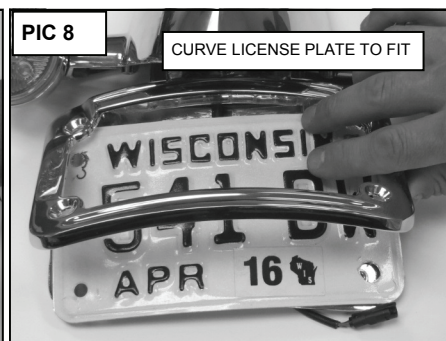
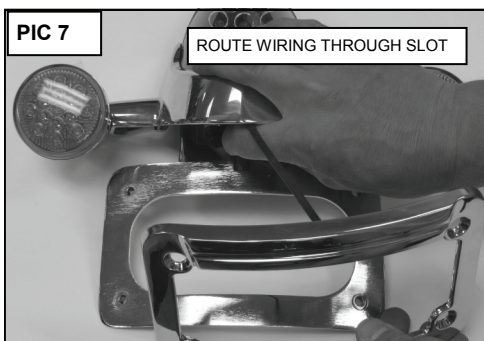
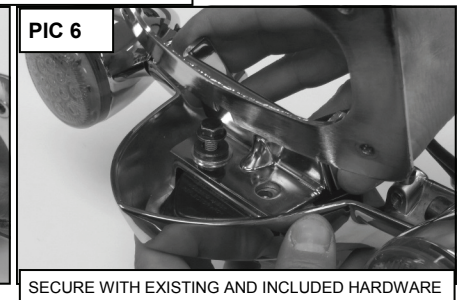
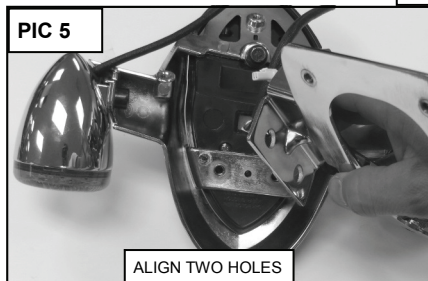
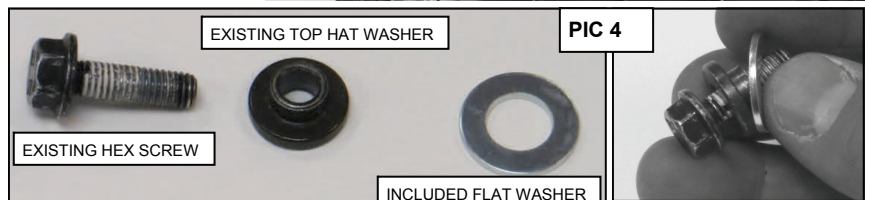
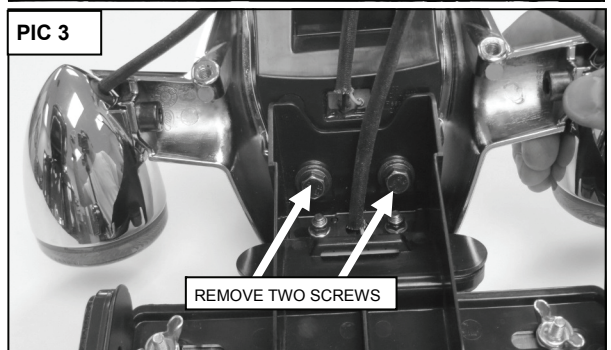



**STEP 10** Loop the included Cable Tie through the keeper on the backside of the assembly as shown in **PIC 10**.

Do not tighten the Cable Tie at this time.

**STEP 11** Protect the fender with painter's/masking tape as shown in **PIC 11**.

Reconnect the four connectors; the left and right turn signal connectors are **NOT** side-specific, ensure they attach to the corresponding connector.

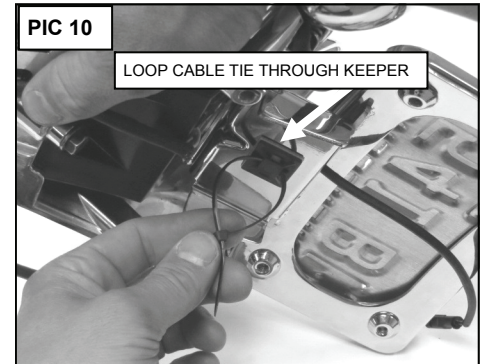

### NOTICE

Secure the wiring away from moving parts, pinch points, or extreme heat. Kuryakyn will not provide warranty coverage on any electrical component that fails due to pinched, crimped, broken, abraded, melted, or frayed wires.

**STEP 12** Reinstall the main fuse; turn **IGN ON** and test the turn signals, run and brake light function and license plate light.

**STEP 13** Route the wiring between the existing assembly and the new Backing Plate as shown in **PIC 11**.

Fold the remaining wiring into the Cable Tie loop made in **STEP 10**; tighten the Cable Tie.

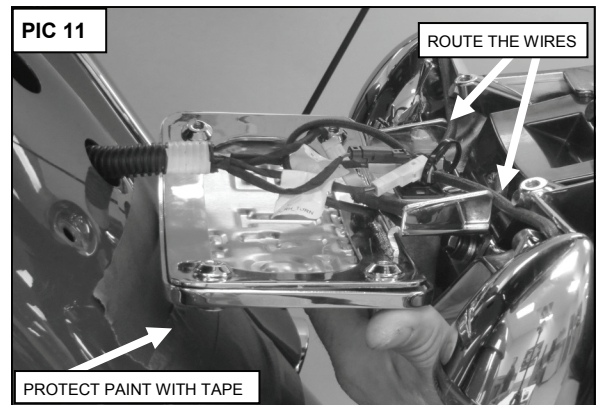

**STEP 14** Align the Plate/signal assembly with the fender; secure it with the existing screws; start with the two side screws first, then the upper screw. Leave all three loose. Remove and discard the masking tape.

**STEP 15** Refer to **PIC 12**. Carefully slide the existing gasket behind the assembly; ensure that the gasket flange hooks over the upper edge of the assembly; tighten the three screws inside the fender.



**NOTE:** The included foam pad can be used to reduce vibration. Attach the pad to the inside of the Backing Plate.

### WARNING

VISIBILITY IS A **MAJOR CONCERN** FOR MOTORCYCLISTS. A LIGHT MALFUNCTION COULD RESULT IN DEATH OR SERIOUS INJURY. ENSURE PROPER LIGHT OPERATION **BEFORE RIDING** THE MOTORCYCLE.

### NOTICE

It is the end user's responsibility to ensure that all fasteners (including pre-assembled) are tightened before operation of the motorcycle. Kuryakyn will not provide warranty coverage on products or components lost or damaged due to improper installation or lack of maintenance. Periodic inspection and maintenance are required on all fasteners.

#### LIMITED WARRANTY

Kuryakyn warrants that any Kuryakyn products sold hereunder, shall be free of defects in materials & workmanship for a period of one (1) year from the date of purchase by the consumer excepting the following provisions:

1. Kuryakyn shall have no obligation in the event the customer is unable to provide a receipt showing the date the customer purchased the product(s).
2. The product must be properly installed, maintained & operated under normal conditions.
3. Kuryakyn shall not be liable for any consequential & incidental damages, including labor & paint, resulting from failure of a Kuryakyn product, failure to deliver, delay in delivery, delivery in nonconforming condition, or for any breach of contract or duty between Kuryakyn & a customer.
4. Kuryakyn products are often intended for use in specific applications. Kuryakyn makes no warranty if a Kuryakyn product is used in applications other than intended.
5. Kuryakyn electrical products are warranted for one (1) year from the date of purchase by the consumer. L.E.D.'s contained in components of Kuryakyn products will be warranted for defects in materials & workmanship for 3 years from the date of purchase whereas all other components shall be warranted for one (1) year.
6. Merchandise purchased directly from Internet auction sites or any other third party seller is considered sold as is & shall not carry a Kuryakyn warranty. All warranty claims must be directed to the original seller. If unsure please contact the seller to verify they are an authorized Kuryakyn retailer.

#### RETURN POLICY

Merchandise determined to be defective may be returned up to one year from the date of purchase. Returns must be processed through original seller. Returned merchandise for any other reason other than warranty claims must be in like new condition & subject to a 20% restocking fee. All returns are subject to inspection for determination of full or partial credit. Any returned part that shows evidence of being used or installed contrary to manufacturer's instructions, &/or subjected to improper handling, packaging or return shipping by the customer, will not be eligible for exchange, refund or warranty consideration. All returned electrical items will be inspected & tested. If electrical item is deemed functional, no credit will be issued & item will be returned. All sales are final on discontinued or closeout merchandise.