



INSTALLATION

ERGO III ADJUSTABLE CRUISE MOUNT & CLEVIS

4080

THANK YOU FOR CHOOSING KÜRYAKYN!

PROTECT YOURSELF AND OTHERS FROM POSSIBLE INJURY AND/OR PROPERTY DAMAGE OR LOSS. PAY CLOSE ATTENTION TO ALL INSTRUCTIONS, WARNINGS, CAUTIONS, AND NOTICES REGARDING THE INSTALLATION, USE, AND CARE OF THIS PRODUCT.

WARNING

THIS INDICATION ALERTS YOU TO THE FACT THAT IGNORING THE CONTENTS DESCRIBED HEREIN CAN RESULT IN POTENTIAL DEATH OR SERIOUS INJURY.

CAUTION

This indication alerts you to the fact that ignoring the contents described herein can result in minor or moderate potential injury.

NOTICE

This indication alerts you to the fact that ignoring the contents described herein may negatively affect product performance and functionality or damage the product itself or the product to which it is being attached.

MAKE SURE THE FOLLOWING PARTS HAVE BEEN INCLUDED IN THE KIT:

- 1 Brake-Side (Right) Rotating Arm Assembly
- 1 Clutch-Side (Left) Rotating Arm Assembly
- 1 Hardware Kit Containing:
 - 2 Fixed Position Stoppers
 - Bearing Grease
 - 2 Compression Springs
 - 2 Brass Bushings
 - 2 Steel Bushings
- 1 Installation Instructions

TOOLS SUGGESTED

Set of Hex and Combination Wrenches, Hex Bit Socket Set with Ratchet, FT/LBS Torque Wrench, Non-Permanent Marker, Measuring Tape or Ruler

NOTICE

If installing this product for another party, please make sure they receive this copy of the installation instructions so they are aware of the important information contained in them.

NOTICE

These Ergo 3 Arm and Clevis assemblies require the use of existing Ergo II mounts on the motorcycle and require the use of footpegs equipped with H-D style "MALE" mounts.

NOTE: In the following instructions, left and right may be referred to as "clutch-side" (left) and "brake-side" (right) for clarity.

CUSTOMER SERVICE

877.370.3604 (toll free)

INSTALLATION QUESTIONS

techsupport@kuryakyn.com
or call 715.247.2983

LIMITED WARRANTY

Kuryakyn warrants that any Kuryakyn products sold hereunder, shall be free of defects in materials and workmanship for a period of one (1) year from the date of purchase by the consumer excepting the following provisions:

- Kuryakyn shall have no obligation in the event the customer is unable to provide a receipt showing the date the customer purchased the product(s).
 - The product must be properly installed, maintained and operated under normal conditions.
 - Kuryakyn makes no warranty, expressed or implied, with respect to any gold plated products.
 - Kuryakyn shall not be liable for any consequential and incidental damages, including labor and paint, resulting from failure of a Kuryakyn product, failure to deliver, delay in delivery, delivery in nonconforming condition, or for any breach of contract or duty between Kuryakyn and a customer.
- Kuryakyn products are often intended for use in specific applications. Kuryakyn makes no warranty if a Kuryakyn product is used in applications other than intended.
- Kuryakyn electrical products are warranted for one (1) year from the date of purchase by the consumer. L.E.D.'S contained in components of Kuryakyn products will be warranted for defects in materials and workmanship for 3 years from the date of purchase where as all other components shall be warranted for one(1) year. This includes, but is not limited to; control modules, wiring, chrome & other components.

- Kuryakyn makes no warranty of any kind in regard to other manufacturer's products distributed by Kuryakyn. Kuryakyn will pass on all warranties made by the manufacturer and where possible, will expedite the claim on behalf of the customer, but ultimately, responsibility for disposition of the warranty claim lies with the manufacturer.

ABOUT OUR CATALOG

For purchasing Kuryakyn® products, you can receive a complete catalog free of charge. Send the Proof-of-Purchase below with your address to: Kuryakyn, P.O. Box 339, Somerset, WI 54025. Please indicate either Accessories Catalog for Harley-Davidson® or GL & Metric Cruisers.

Be sure to ask your local dealer about other Kuryakyn® products, the motorcycle parts and accessories designed for riders by riders.

©2005 Kuryakyn USA® All Rights reserved.



kuryakyn.com

STEP 1

Read and understand all steps in the instructions before starting the installation. Park the motorcycle on a hard, level surface and turn off the ignition. Put the bike on its center stand or secure it to a lift table. Allow the engine and exhaust system to cool.



YOU WILL BE WORKING AROUND THE ENGINE AND EXHAUST SYSTEM DURING INSTALLATION. ENSURE THAT THE ENGINE AND EXHAUST SYSTEM HAVE FULLY COOLED TO PREVENT INJURY.

BIKE PREP:

STEP 2

Remove both existing Ergo II arms and pegs from the Ergo II mounts on the motorcycle. Set the arms and hardware aside, they will not be reused. **The Ergo II mount will remain on the engine guard.**

PRE-ASSEMBLY:

STEP 3

Locate the clutch-side (left) **Rotating Arm**, **Helix**, and an **End Cap** (FIG 1 on **PAGE 3**). The inside of the Arm and Helix are marked with an "L". PIC 1a The Arms and Helix are side specific; ensure you have the correct Rotating Arm and Helix **before** moving on. PIC 1b shows the right side.

STEP 4

Refer to PIC 1a. Position the Helix in the Rotating Arm EXACTLY as shown in PIC 1a. PIC 1b shows the right side.

STEP 5

Hold the Helix in place in the Rotating Arm and position the End Cap over the nose of the Helix. PIC 2 Turn the End Cap until it settles into place on the nose of the Helix as shown in PIC 3.

STEP 6

Holding everything in place, make a mark on the End Cap and Rotating Arm with a non-permanent marker as shown in PIC 4.

STEP 7

Test fit the assembly on the Ergo II mount. PIC 5 With the Helix engaged on the cogs of the Ergo II mount, pull up on the arm to ensure that the Arm assembly is parallel to the engine guard and valve cover.

-cont.-

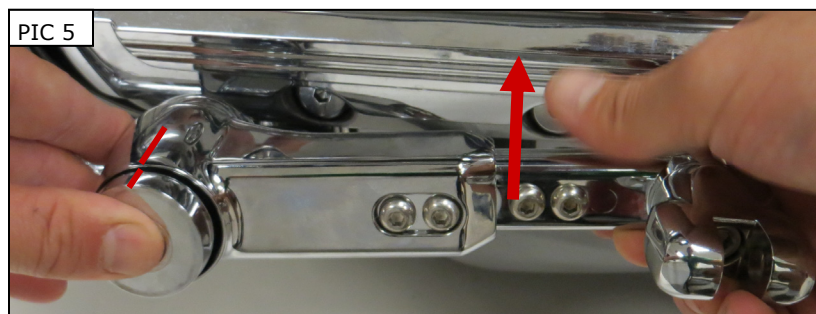
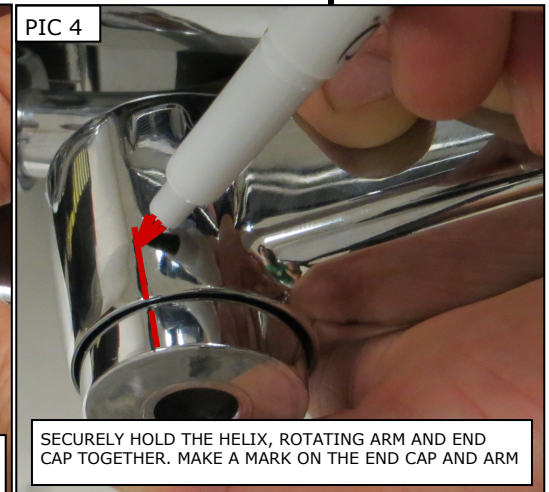
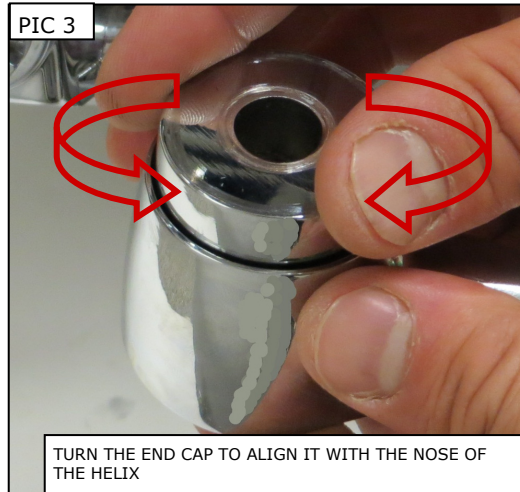
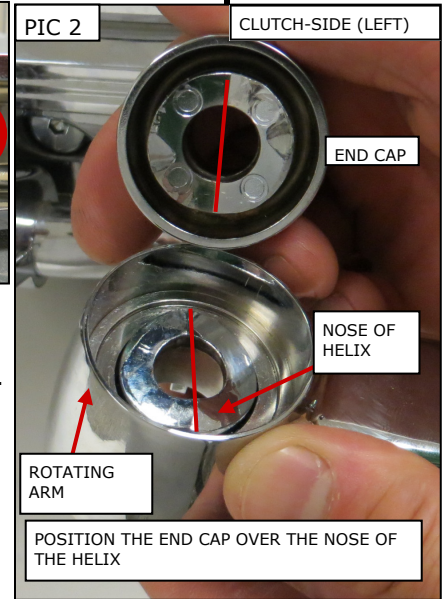
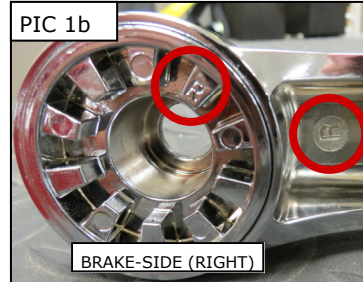
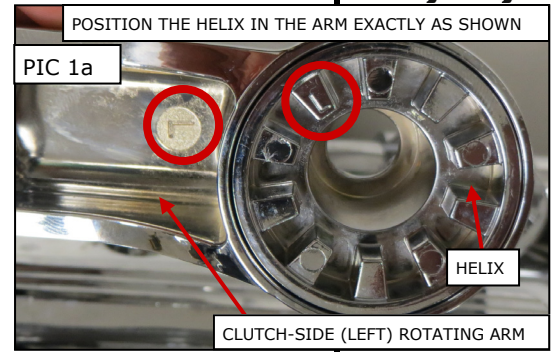

STEP 8 Remove the Arm assembly from the Ergo II mount. Apply a liberal amount of the included Grease to both inside surfaces of the Rotating Arm, to the ramps and nose of the Helix, and the inside of the End Cap. FIG 1 Use one Grease packet per side.

STEP 9 Refer to FIG 1. Insert a **Brass Bushing** then a **Steel Bushing** in the Rotating Arm. Add a dab of Grease on the Bushings to keep them in place during installation.

STEP 10 Re-assemble the Helix in the Rotating Arm EXACTLY AS BEFORE in **STEP 4**. Set within arms reach of the work area.

STEP 11 Insert an included 1/2"-13 X 2-1/4" Socket Head Cap Screw through a Washer, End Cap, and Spring. FIG 2 Set within arms reach of the work area.

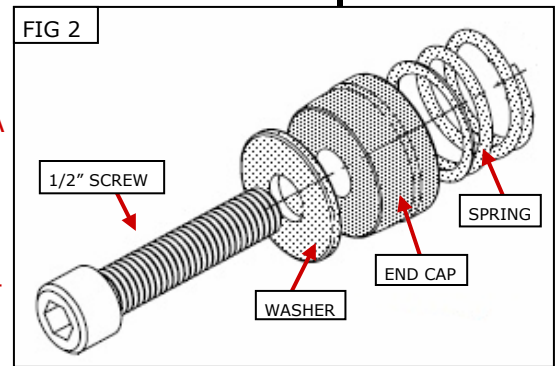
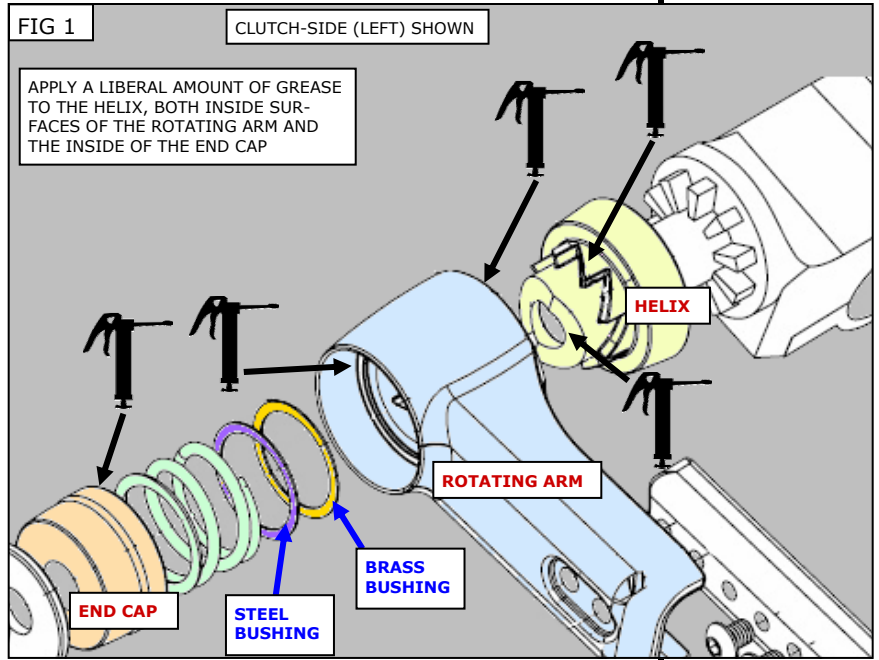

THE ROTATING ARM CAN BE POSITIONED IN A WAY THAT GREATLY DECREASES CORNERING CLEARANCE WHICH MAY CAUSE LOSS OF CONTROL RESULTING IN SERIOUS INJURY OR DEATH. ENSURE THAT THE ROTATING ARM IS POSITIONED PARALLEL TO OR ABOVE THE ENGINE GUARD WHEN IN THE UNLOADED POSITION. REMOVE YOUR FEET FROM THE FOOT-PEG WHEN CORNERING TO AVOID LOSS OF CONTROL.

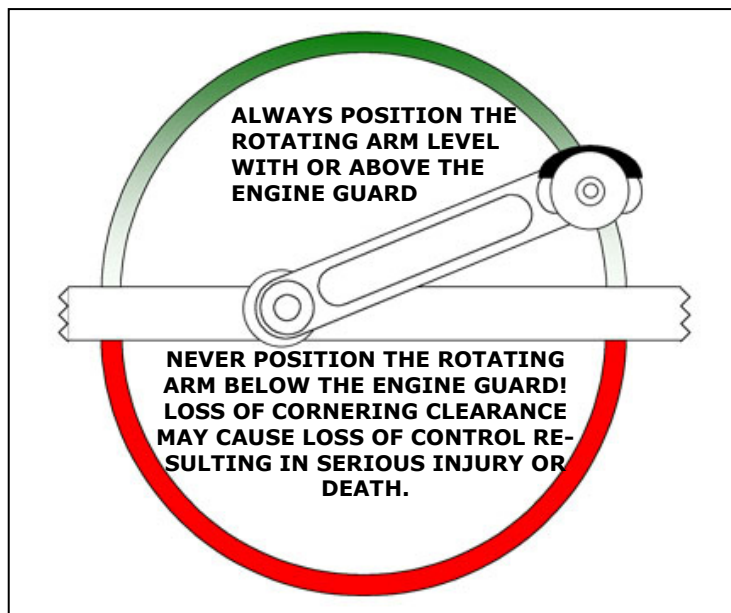

-cont.-

ROTATING ARM ASSEMBLY INSTALLATION:

STEP 12 Position the Rotating Arm assembly (PIC 6 and 7) on the Ergo II mount EXACTLY AS BEFORE in **STEP 7**. Ensure that the Arm is parallel to the engine guard and valve cover.

STEP 13 Insert 1/2" Screw with the hardware (from **STEP 11**) through the Arm and Helix. PIC 6 and 7 **Torque the 1/2" Screw to 30 FT/LBS**. Ensure the marks (from **STEP 6**) stay aligned as you tighten the screw.

Step 14 Using a measuring tape or ruler, ensure that exactly 3/8" of the End Cap protrudes from the assembly. PIC 8 **Do not include the thickness of the washer**. If necessary, loosen the 1/2" Screw and "re-seat" the End Cap as you re-tighten the screw. This will ensure that the End Cap is properly aligned with the nose of the Helix.

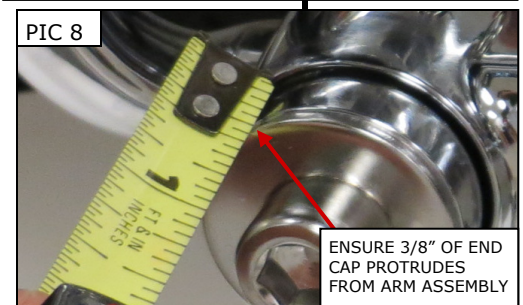
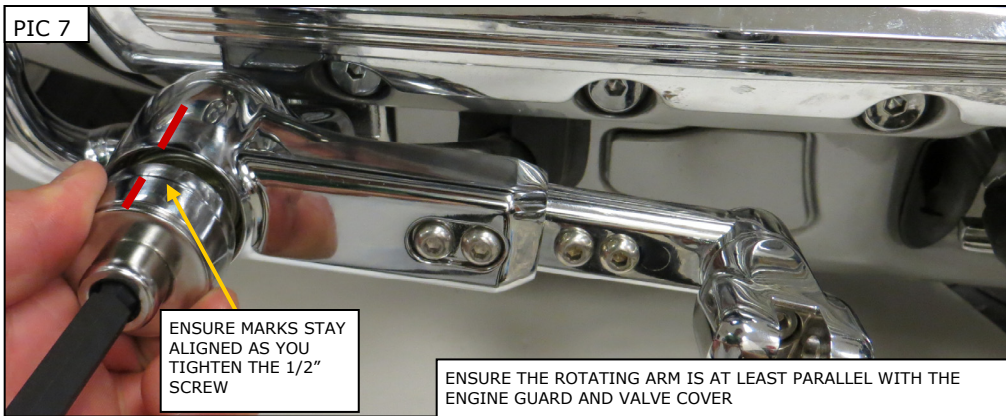
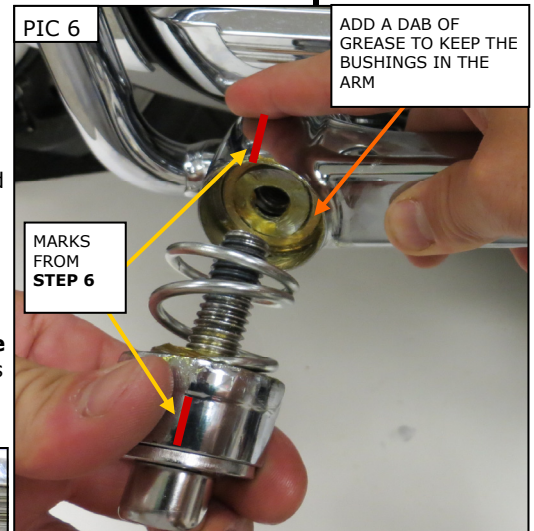

FOOTPEG AND CLEVIS INSTALLATION AND ADJUSTMENT:

NOTE: Place a drop of Loctite Thread-locker Blue 248 on the threads of the clevis and footpeg screws before installing. Follow the manufacturer's recommendations for proper application.

STEP 15 Refer to PIC 9. Remove the clevis-mounting screw and apply some Blue Loctite (248) to the threads. Reinstall the screw. Push down on the Rotating Arm until it reaches its stop; adjust the angle of the clevis so the footpeg will fold up and back at an angle. Ensure the splines on the clevis and arm engage and tighten the clevis-mounting screw. **Torque the screw to 20 FT/LBS.**

Step 16 Apply some Blue Loctite (248) to the clevis screw threads. Install the clutch-side footpeg in the clevis and secure it with the clevis screw. PIC 10 If necessary, use the included Wave Washers to take up any excess space between the footpeg adapter and the clevis. **Torque the screw to 25 FT/LBS.**

STEP 17 Loosen the footpeg screw to adjust the footpeg angle. Tighten the footpeg screw.

STEP 18 Repeat **STEPS 3 through 17** for the right side.

-cont.-

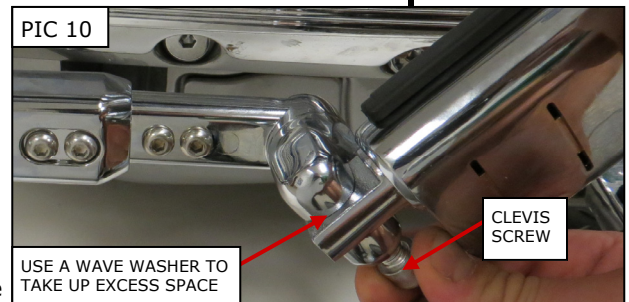
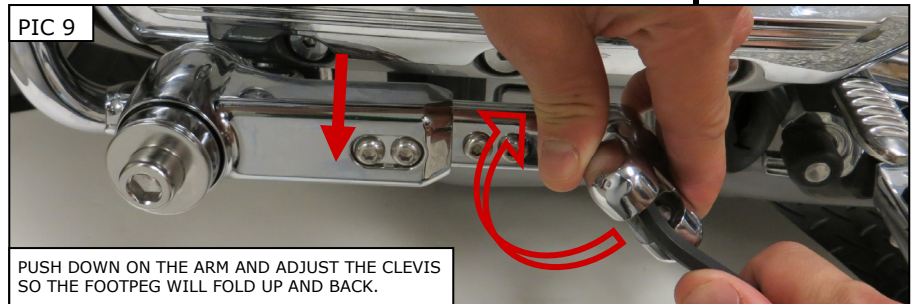

ERGO III ROTATING ARM ADJUSTMENT:

STEP 19 With the motorcycle on the center stand or secured to a lift table, get on the motorcycle and test the positioning of the Ergo III arms and pegs for fit and function.

WARNING

THE ROTATING ARM CAN BE POSITIONED IN A WAY THAT GREATLY DECREASES CORNERING CLEARANCE WHICH MAY CAUSE LOSS OF CONTROL RESULTING IN SERIOUS INJURY OR DEATH. ENSURE THAT THE ROTATING ARM IS POSITIONED PARALLEL TO OR ABOVE THE ENGINE GUARD WHEN IN THE UNLOADED POSITION. REMOVE YOUR FEET FROM THE FOOTPEG WHEN CORNERING TO AVOID LOSS OF CONTROL.

STEP 20 The Ergo III Adjustable Cruise Mount has been pre-assembled in the shortest leg position. If you need more leg room, remove the two 1/4"-20 X 1 1/8" Button Head screws, Nylock Nuts and one or both of the plug screws. PIC 11 Adjust the Arm length to your comfort and reinstall the screws. **Torque the screws to 10 FT/LBS.** Install the two Nylock Nuts. Install the plug screws as needed. Refer to PIC 11 for the proper use of the plug screws. **Torque the plug screws to 10 FT/LBS.**

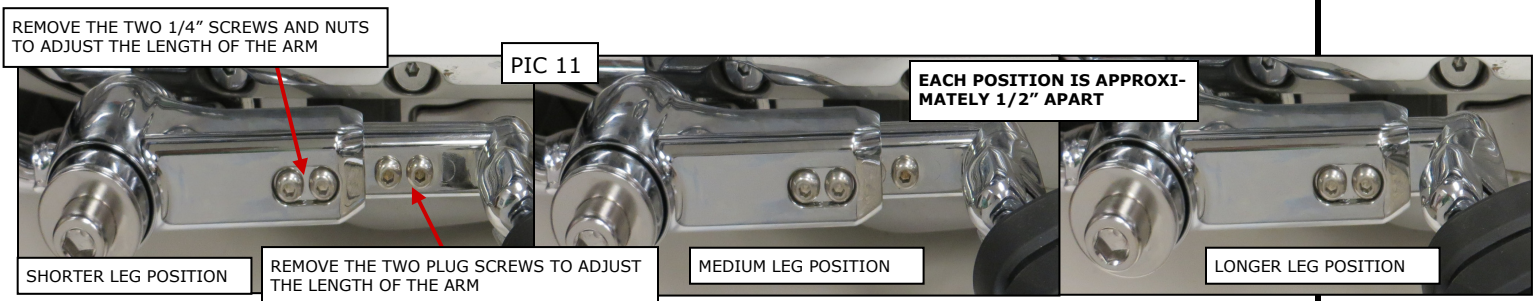

STEP 21 Confirm that the pegs fit and function properly **BEFORE** riding the motorcycle. The Ergo III Adjustable Cruise Arms **MUST** return on their own when your feet are removed from the pegs.

OPTIONAL HORIZONTAL FIXED-POSITION INSTALLATION:

STEP 22 The Ergo III Adjustable Cruise Mounts can be assembled as stationary footrests. Remove the 1/2" screw from the Arm assembly. Take the Arm off of the mount and replace the Spring and Bushings with the included Fixed Position Stoppers. Reapply Loctite Threadlocker Blue 248 to the threads of the 1/2" screw and torque to 30 FT/LBS. Follow Loctite's recommendations for proper application. Refer to STEPS 3 through 7 for reinstallation. Ensure that the End Cap remains aligned with the nose of the Helix while the screw is tightened. Repeat for the other side.

ERGO III ADJUSTABLE CRUISE MOUNT CARE:

Do not wash with a pressure washer. The water pressure may remove the grease.

Periodic greasing may be necessary to maintain proper function.

NOTICE

Ride On!

It is the end user's responsibility to ensure that all of the fasteners (including pre-assembled) are tightened before operation of the motorcycle. Küryakyn will not provide warranty coverage on products or components lost due to improper installation or lack of maintenance. Periodic inspection and maintenance are required on all fasteners.

PAGE
5