



Custom Dynamics® Individual Plasma Rods™ Installation Instructions

We thank you for purchasing the Custom Dynamics® LED Plasma Rod™! Our products utilize the latest technology and high quality components to ensure you the brightest, most reliable LED's on the market. We offer one of the best warranty programs in the industry and we back our products with excellent customer support, if you have questions before or during installation of this product please call Custom Dynamics® at 1(800) 382-1388.

Package Includes:

- Individual Amber or Red Plasma Rod™
- 3M™ Double-Sided Tape (installed)
- 3M™ Promoter Ampule (1)
- Posi-Taps® (2)

Installation

1. Select location for mounting the Plasma Rod. Make sure that you have enough flat surface to properly adhere to.
2. Using the included 3M™ Promoter Ampule, apply to the surface area that the Plasma Rod™ will adhere to, allow 4-5 minutes to dry.
3. Remove a few inches of the red backing from the tape on one end, fold towards you for enough to grab onto to remove the rest in a minute. Attach the end of the Plasma Rod™ to the desired location, once started, slowly pull on the red backing to remove, pressing down on the rod as you go until completely adhered.

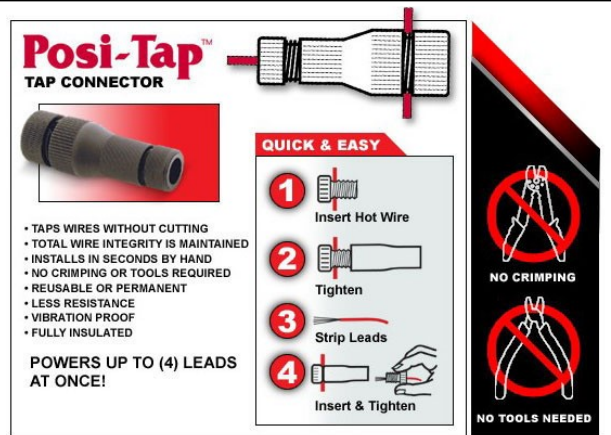

This product is designed and intended for use as auxiliary lighting only. It is NOT intended to replace any original equipment lighting installed on the vehicle and should not be used for that purpose. This product must be wired so that it does not interfere with any original equipment lighting.

Wiring:

Using the supplied Posi-Tap™ Connectors, follow the wiring instructions below:

4. Connect the Plasma Rod™ black wires to a good ground source on the bike.
5. Connect the red or amber wire from the Plasma Rod™ to the desired function on the bike.
6. Check operation of Plasma Rod™.

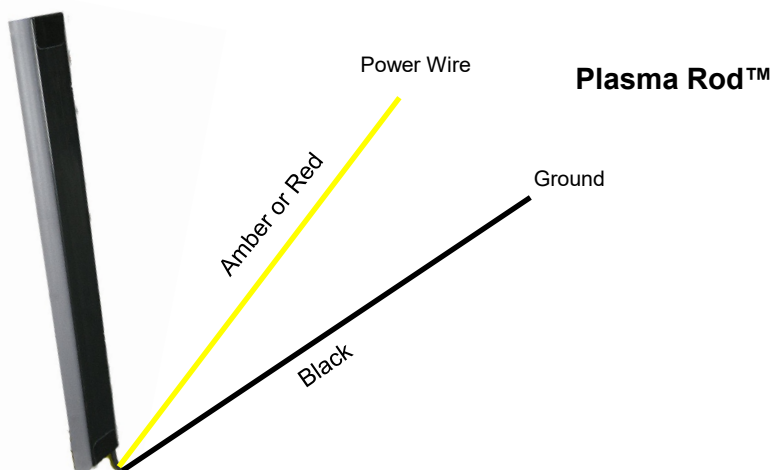

Questions? Call us at: 1 (800) 382-1388 M-TH 8:30AM-5:30PM / FR 9:30AM-5:30PM EST