



## QUICK ADJUST RELOCATOR FOR TOUR-PAK

### 8973

### PARTS INCLUDED

- 1 Base Plate Assembly
- 1 Right Side Extruded Slider Assembly
- 1 Left Side Extruded Slider Assembly
- 1 Filler Panel
- 1 Hardware Kit
  - 1 Stop Block
  - 2 1/4"-20 x 1/2" Hex Head Cap Screws
  - 10 1/4"-20 Nylon Locking Nuts
  - 12 1/4" Flat Washers
  - 8 1/4"-20 x 7/8" Hex Head Cap Screws
  - 10 1/4"-20 x 1-3/8" Hex Head Cap Screws
  - 4 #8 X 1/2" Phillips Head Screws
  - 4 #8 Wide Flat Washers
- 1 Installation Instructions

Please read and understand entire instructions before starting installation.

### THANK YOU FOR CHOOSING KÜRYAKYN!

**IN ORDER TO PROTECT YOU AND OTHERS FROM POSSIBLE INJURY AND/OR PROPERTY DAMAGE OR LOSS, PLEASE PAY CLOSE ATTENTION TO ALL INSTRUCTIONS, WARNINGS, CAUTIONS AND ATTENTION NOTES REGARDING THE USE AND CARE OF THIS PRODUCT.**

**WARNING!** THIS INDICATION ALERTS YOU TO THE FACT THAT IGNORING THE CONTENTS DESCRIBED HEREIN CAN RESULT IN POTENTIAL DEATH OR SERIOUS INJURY.

**ATTENTION!** This indication alerts you to the fact that ignoring the contents described herein may negatively affect product performance and functionality.

**CAUTION!** This indication alerts you to the fact that ignoring the contents described herein can result in potential injury or material damage.

### TOOLS SUGGESTED

Set of Hex Wrenches, Combination Wrenches, Socket Set with Ratchet, Drill & 17/64" Drill Bit

**STRICTLY OBSERVE THE FOLLOWING GUIDELINES IN ORDER TO USE THE PRODUCT PROPERLY AND AVOID POTENTIALLY DANGEROUS ACCIDENTS.**

**STEP 1** This step is for all model years. Read and understand all steps in the instructions before starting the installation. Park the motorcycle on a hard, level surface and turn off the ignition. Remove the seat.

**NOTE:** Not compatible with amplifiers found on stock '08 and earlier Screamin' Eagle models or included in H-D "Enhanced Sound" system. Not compatible with Leather Tour-Paks.

**NOTE:** Will fit '98-early '00 Touring Models with rigid mounted Tour-Paks if the stock support bar has been updated to the late '00-'08 style support bar.

**NOTE:** Correct placement of specified hardware is extremely important for proper function of this product.

### CUSTOMER SERVICE

877.370.3604 (toll free)

### INSTALLATION QUESTIONS

techsupport@kuryakyn.com  
or call 715.247.2983

### LIMITED WARRANTY

Kuryakyn warrants that any Kuryakyn products sold hereunder, shall be free of defects in materials and workmanship for a period of one (1) year from the date of purchase by the consumer excepting the following provisions:

- Kuryakyn shall have no obligation in the event the customer is unable to provide a receipt showing the date the customer purchased the product(s).
  - The product must be properly installed, maintained and operated under normal conditions.
  - Kuryakyn makes no warranty, expressed or implied, with respect to any gold plated products.
  - Kuryakyn shall not be liable for any consequential and incidental damages, including labor and paint, resulting from failure of a Kuryakyn product, failure to deliver, delay in delivery, delivery in nonconforming condition, or for any breach of contract or duty between Kuryakyn and a customer.
- Kuryakyn products are often intended for use in specific applications. Kuryakyn makes no warranty if a Kuryakyn product is used in applications other than intended.
- Kuryakyn electrical products are warranted for one (1) year from the date of purchase by the consumer. L.E.D.'S contained in components of Kuryakyn products will be warranted for defects in materials and workmanship for 3 years from the date of purchase where as all other components shall be warranted for one(1) year. This includes, but is not limited to; control modules, wiring, chrome & other components.
- Kuryakyn makes no warranty of any kind in regard to other manufacturer's products distributed by Kuryakyn. Kuryakyn will pass on all warranties made by the manufacturer and where possible, will expedite the claim on behalf of the customer, but ultimately, responsibility for disposition of the warranty claim lies with the manufacturer.

### ABOUT OUR CATALOG

For purchasing Kuryakyn® products, you can receive a complete catalog free of charge. Send the Proof-of-Purchase below with your address to: Kuryakyn, P.O. Box 339, Somerset, WI 54025. Please indicate either Accessories Catalog for Harley-Davidson® or GL & Metric Cruisers.

Be sure to ask your local dealer about other Kuryakyn® products, the motorcycle parts and accessories designed for riders by riders.

©2005 Kuryakyn USA® All Rights reserved.



kuryakyn.com

**WARNING!** DO NOT EXCEED THE OEM WEIGHT LIMITATIONS OF THE TOUR-PAK.

**Instructions for Specific Models:**

- For 09-up Touring models, including CVO Touring Models - Pg 2
- For 09-up Touring models with detachable Tour-Pak - Pg 3
- For 06-08 Touring models - Pg 4
- For 00-05 Touring models - Pg 5
- For 97-08 Touring models with detachable Tour-Pak - Pg 6

**For 09-up Touring Models**

**STEP 2** Open the Tour-Pak and remove the liner. Remove the hardware securing the Tour-Pak to the support bracket - save this hardware, it will be re-used. Remove the Tour-Pak from the support bracket. PIC 1 On CVO models, there will be a black Amplifier support plate on the support bracket. Leave this plate in place. PIC 2 Rotate the Tour-Pak forward, resting it where the seat would be.

**CAUTION!** Avoid damage to the motorcycle. Protect painted surfaces with a soft cloth or blanket.

**NOTE:** Be careful of the wiring harness, cut any zip ties or wire clips securing the wiring harness.

**STEP 3** As shown in PIC 3, place the base plate over the support bracket. On CVO models, set the base plate on top of the black amplifier bracket that is on the support bracket. Line up the holes in the base plate with the threaded holes in the support bracket and thread the stock hardware removed in Step 2 through the base plate and in to the support bracket. Tighten the hardware.

**ATTENTION!** It is the installer's responsibility to ensure that all of the fasteners (including preassembled) are tightened before operation of the motorcycle. Küryakyn will not warranty components lost due to improper installation. Periodic maintenance may be required.

**STEP 4** On the underside of the Tour-Pak, hold the extruded aluminum sliders (as shown in PIC 4) in place lining up the holes in the Tour-Pak with the holes in the sliders.

**NOTE:** It may be helpful to push the 1/4"-20 x 7/8" hex head cap screws (with 1/4" washers) through the Tour-Pak first to help line up the sliders.

**STEP 5** As shown in PIC 4 (red circles), loosely install the 1/4"-20 nylon locking nuts for now.

**NOTE:** The hardware can be installed in either front or back holes.

**STEP 6** Make sure that the gap (PIC 4) between the sliders is equal and tighten the hardware securing the sliders to the underside of the Tour-Pak.

**NOTE:** If sliders are not parallel, they will bind in the channels and the Tour-Pak will not move smoothly.

**ATTENTION!** It is the installer's responsibility to ensure that all of the fasteners (including pre-assembled) are tightened before operation of the motorcycle. Küryakyn will not warranty components lost due to improper installation. Periodic maintenance may be required.

**STEP 7** As shown in PIC 5, align the sliders with the locking shoes on the base plate. The locking shoes fit inside the sliders. It may be necessary to loosen the locking shoes to get them to fit inside the sliders.

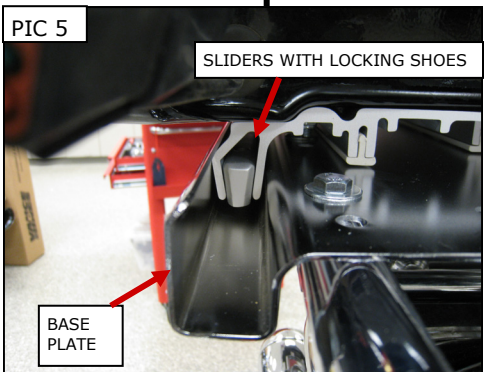
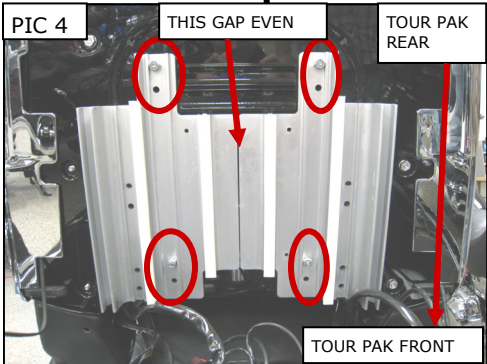
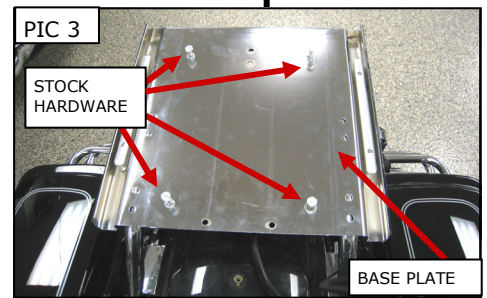
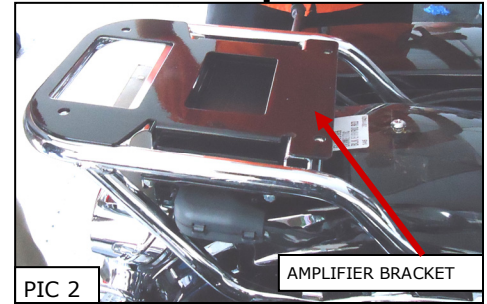
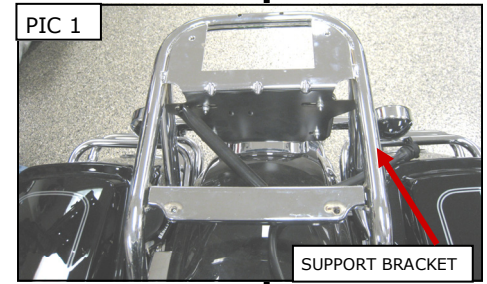

-cont.-

**STEP 8** Slide the Tour-Pak back until it stops. As shown in PIC 6, secure the stop block to the base plate using the 1/4"-20 x 1/2" hex head cap screws and 1/4" flat washers. Place the stop block on top of the base plate and secure from the underside.

**STEP 9** Test that the Tour-Pak moves freely and that no wires are stretched or pinched at any point. Secure the wire harness so that the Tour-Pak can move freely.

**STEP 10** To secure the Tour-Pak in place, turn all 4 locks (PIC 7) until snug and rotate the levers up until they lock in place between the nylon anti-rotation stops. **You should not need to use any type of tool for leverage to tighten the locks sufficiently. You should be able to feel the lever snap into place when folded over. If you do not feel a positive snap when folding the lever, it may be too tight. Loosen 1/2 turn and fold over again.** Test that the Tour-Pak is secure before using the motorcycle.

**CAUTION!** Before each ride inspect to ensure the levers are folded over in place and that the Tour-Pak is secure.

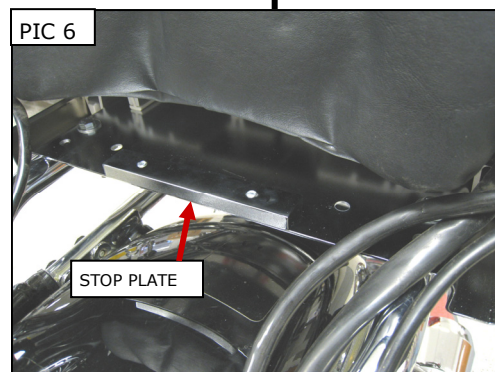

**For 09-up Touring Models with Detachable Tour-Pak**

**STEP 2** Open the Tour-Pak and remove the liner. Remove the hardware securing the Tour-Pak to the support bracket - save this hardware, it will be re-used. Remove the Tour-Pak from the support bracket and (if possible) put the Tour-Pak on a covered workbench. If installing on the bike, rotate the Tour-Pak forward, resting it where the seat would be.

**CAUTION!** Avoid damage to the motorcycle. Protect painted surfaces with a soft cloth or blanket.

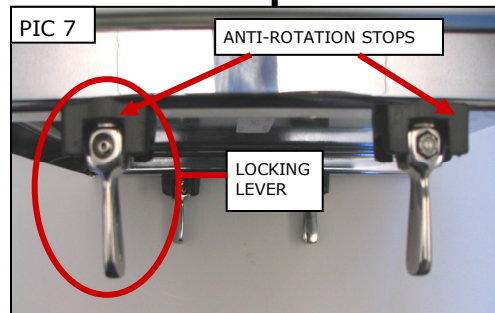

**NOTE:** Be careful of the wiring harness, cut any zip ties or wire clips securing the wiring harness.

**STEP 3** Place the base plate over the support bracket. Line up the holes in the base plate with the holes in the support bracket (PIC 8) and secure using the stock hardware removed in Step 2 through the base plate and in to the support bracket. Tighten the hardware. Using a 17/64" drill bit, drill holes through the front stop block mounting holes in the base plate and through the support bracket.

**ATTENTION!** It is the installer's responsibility to ensure that all of the fasteners (including pre-assembled) are tightened before operation of the motorcycle. Küryakyn will not warranty components lost due to improper installation. Periodic maintenance may be required.

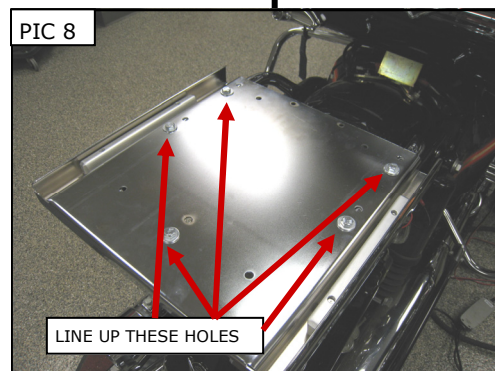

**STEP 4** Follow Steps 4-10 in the "for 09-up Touring models" section above.

**STEP 5** Tighten all hardware and make sure the Tour-Pak is secure before operating the motorcycle.

**ATTENTION!** It is the installer's responsibility to ensure that all of the fasteners (including pre-assembled) are tightened before operation of the motorcycle. Küryakyn will not warranty components lost due to improper installation. Periodic maintenance may be required.

**FOR '06-'08 Touring Models - Injection Molded Tour-Pak**

**STEP 2** Open the Tour-Pak and remove the liner. Remove the hardware securing the Tour-Pak to the support bracket - save this hardware, some of it will be re-used. Remove the Tour-Pak from the support bracket and rotate the Tour-Pak forward, resting it where the seat would be.

-cont.-

**CAUTION!** Avoid damage to the motorcycle. Protect painted surfaces with a soft cloth or blanket.

**NOTE:** Be careful of the wiring harness, cut any zip ties or wire clips securing the wiring harness.

**STEP 3** As shown in PIC 9, place the base plate over the support bracket. Line up the holes in the base plate with the holes in the support bracket. Insert the 1/4"-20 x 1-3/8" hex head cap screws and 1/4" flat washers through the 5 holes in the base plate. As shown in PIC 10, using the stock U-channels and stock washers, tighten the hardware.

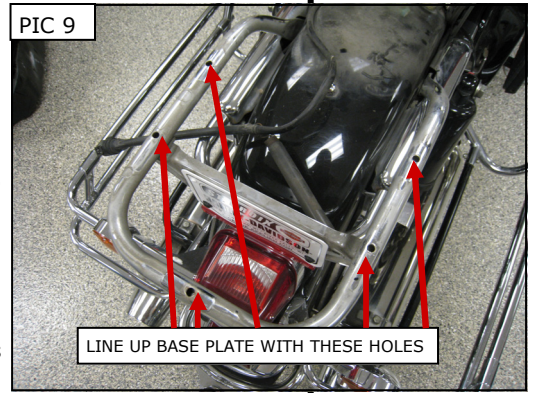

**STEP 4** On the underside of the Tour-Pak, hold the extruded aluminum sliders (as shown in PIC 11) in place lining up the holes in the Tour-Pak with the holes in the sliders.

**NOTE:** It may be helpful to push the 1/4"-20 x 7/8" hex head cap screws (with 1/4" flat washers) through the Tour-Pak first to help line up the sliders.

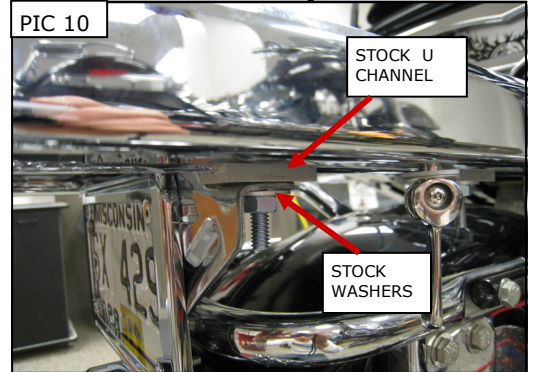

**STEP 5** As shown in PIC 11 (red circles), loosely install the 1/4"-20 nylon locking nuts for now.

**NOTE:** The hardware can be installed in either front or back holes.

**STEP 6** Make sure that the gap (PIC 11) between the sliders is equal and tighten the hardware securing the sliders to the underside of the Tour-Pak.

**NOTE:** If sliders are not parallel, they will bind in the channels and the Tour-Pak will not move smoothly.

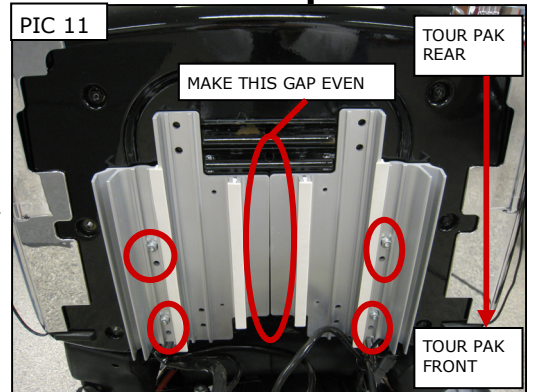

**ATTENTION!** It is the installer's responsibility to ensure that all of the fasteners (including pre-assembled) are tightened before operation of the motorcycle. Küryakyn will not warranty components lost due to improper installation. Periodic maintenance may be required.

**STEP 7** As shown in PIC 5 on Page 2, align the sliders with the locking shoes on the base plate. The locking shoes fit inside the sliders. It may be necessary to loosen the locking shoes to get them to fit inside the sliders.

**STEP 8** Slide the Tour-Pak back until it stops. As shown in PIC 6 on Page 3, secure the stop block to the base plate using the 1/4"-20 x 1/2" hex head cap screws and 1/4" flat washers. Place the stop block on top of the base plate and secure from the underside.

**STEP 9** Test that the Tour-Pak moves freely and that no wires are stretched or pinched at any point. Secure the wire harness so that the Tour-Pak can move freely.

**STEP 10** To secure the Tour-Pak in place, turn all 4 locks (PIC 7 on Page 3) until snug and rotate the levers up until they lock in place. **You should not need to use any type of tool for leverage to tighten the levers sufficiently. You should be able to feel the lever "snap" into place when folded over. If you do not feel a positive snap when folding the lever, it may be too tight. Loosen 1/2 turn and fold over again.** Test that the Tour-Pak is secure before using the motorcycle.

**CAUTION!** Before each ride inspect to ensure the levers are folded over in place and that the Tour-Pak is secure.

**For '00-'05 Touring Models - Fiberglass Tour-Pak**

**STEP 2** Open the Tour-Pak and remove the liner. Remove the hardware securing the Tour-Pak to the support bracket - save this hardware, some of it will be re-used. Remove the Tour-Pak from the support bracket and rotate the Tour-Pak forward, resting it where the seat would be.

**CAUTION!** Avoid damage to the motorcycle. Protect painted surfaces with a soft cloth or blanket.

**NOTE:** Be careful of the wiring harness, cut any zip ties or wire clips securing the wiring harness.

**STEP 3** Place the base plate over the support bracket (PIC 9 on Page 4). Line up the holes in the base plate with the holes in the support bracket. Insert the 1/4"-20 x 1-3/8" hex head cap screws and 1/4" flat washers through the 5 holes in the base plate. As shown in PIC 8, using the stock U-channels and stock washers, secure the base plate to the support bracket using the nylon locking nuts. Tighten the hardware.

**ATTENTION!** It is the installer's responsibility to ensure that all of the fasteners (including pre-assembled) are tightened before operation of the motorcycle. Küryakyn will not warranty components lost due to improper installation. Periodic maintenance may be required.

**STEP 4** Secure the filler panel (PIC 12) loosely behind both the extruded aluminum sliders using the 4 self tapping screws and #8 wide flat washers. On the underside of the Tour-Pak, hold the extruded aluminum sliders (as shown in PIC 11 on Page 4) in place lining up the holes in the Tour-Pak with the holes in the sliders.

**NOTE:** It may be helpful to push the 1/4"-20 x 1-3/8" hex head cap screws (with 1/4" flat washers) through the Tour-Pak first to help line up the sliders.

**STEP 5** As shown in PIC 11 on Page 4 (red circles), loosely install the 1/4"-20 nylon locking nuts for now.

**NOTE:** The hardware can be installed in either front or back holes.

**STEP 6** Make sure that the gap (PIC 11 on Page 4) between the sliders is equal and tighten the hardware securing the sliders to the underside of the Tour-Pak.

**NOTE:** If sliders are not parallel, they will bind in the channels and the Tour-Pak will not move smoothly.

**ATTENTION!** It is the installer's responsibility to ensure that all of the fasteners (including pre-assembled) are tightened before operation of the motorcycle. Küryakyn will not warranty components lost due to improper installation. Periodic maintenance may be required.

**STEP 7** As shown in PIC 5 on Page 2, align the sliders with the locking shoes on the base plate. The locking shoes fit inside the sliders. It may be necessary to loosen the locking shoes to get them to fit inside the sliders.

**STEP 8** Slide the Tour-Pak back until it stops. As shown in PIC 6 on Page 3, secure the stop block to the base plate using the 1/4"-20 x 1/2" hex head cap screws and 1/4" flat washers. Place the stop block on top of the base plate and secure from the underside.

**STEP 9** Test that the Tour-Pak moves freely and that no wires are stretched or pinched at any point. Secure the wire harness so that the Tour-Pak can move freely.

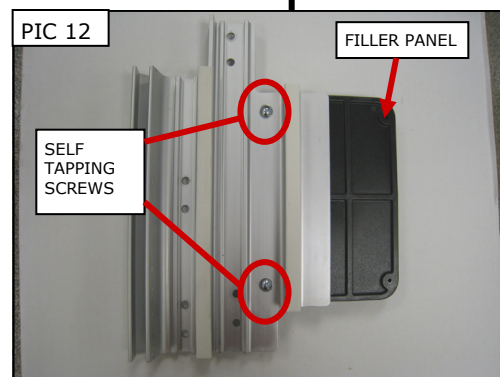

**STEP 10** To secure the Tour-Pak in place, turn all 4 locks (PIC 7 on Page 3) until snug and rotate the levers up until they lock in place. **You should not need to use any type of tool for leverage to tighten the levers sufficiently. You should be able to feel the lever snap into place when folded over. If you do not feel a positive snap when folding the lever, it may be too tight. Loosen 1/2 turn and fold over again.** Test that the Tour-Pak is secure before using the motorcycle.

**CAUTION!** Before each ride inspect to ensure the levers are folded over in place and that the Tour-Pak is secure.

### '97-'08 Touring Models with Detachable Tour-Pak

**STEP 2** Open the Tour-Pak and remove the liner. Remove the hardware securing the Tour-Pak to the support bracket - save this hardware, it will be re-used. Remove the Tour-Pak from the support bracket and (if possible) put the Tour-Pak on a covered workbench. If installing on the bike, rotate the Tour-Pak forward, resting it where the seat would be.

**CAUTION!** Avoid damage to the motorcycle. Protect painted surfaces with a soft cloth or blanket.

**STEP 3** Place the base plate over the support bracket. Line up the holes in the base plate with the holes in the support bracket and secure using the stock hardware removed in Step 2 through the base plate and in to the support bracket. Tighten the hardware.

**ATTENTION!** It is the installer's responsibility to ensure that all of the fasteners (including pre-assembled) are tightened before operation of the motorcycle. Kuryakyn will not warranty components lost due to improper installation. Periodic maintenance may be required.

**STEP 4** For bikes with the injected molded Tour-Paks - Follow Steps 4-10 in the "for '06-'08 Touring models" section above

**STEP 5** For bikes with the fiberglass Tour-Paks - Follow Steps 4-10 in the "for '97-'05 Touring models" section above

**STEP 6** Tighten all hardware and make sure the Tour-Pak is secure before operating the motorcycle.

**ATTENTION!** It is the installer's responsibility to ensure that all of the fasteners (including pre-assembled) are tightened before operation of the motorcycle. Kuryakyn will not warranty components lost due to improper installation. Periodic maintenance may be required.

**CAUTION!** Before each ride inspect to ensure the levers are folded over in place and that the Tour-Pak is secure.

*Ride On!*

PAGE

**6**

**QUICK ADJUST RELOCATOR**

**INSTALLATION**